

**FF Series Couplers BSP Thread**

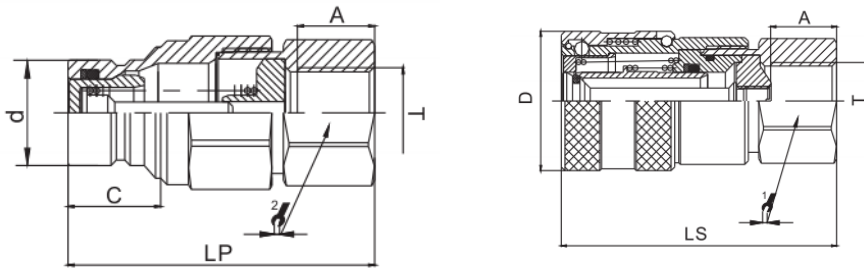

**Features:**

- ◆ Push to connect
- ◆ Pull collar back to disconnect
- ◆ Flat Valves
- ◆ Seals NBR
- ◆ Material steel
- ◆ Conforms to ISO 16208 stand-

**Common Interchange:**

- ◆ Parker FEM
- ◆ Faster FFH
- ◆ Stucchi FIRG
- ◆ Holmbury HQ
- ◆ DNP PLT4
- ◆ Aeroquip FF/FD89

| Size            | 1/8  | 1/4  | 3/8  | 1/2  | 5/8  | 3/4  | 1"   |
|-----------------|------|------|------|------|------|------|------|
| <b>MWP PSI</b>  | 6000 | 6000 | 5000 | 5000 | 5000 | 5000 | 5000 |
| <b>Flow LPM</b> | 12   | 25   | 50   | 110  | 125  | 160  | 230  |

| Body Size | Thread    | Female    | Male      | LP   | LS    | S1 | S2 | Dia D | Dia d |
|-----------|-----------|-----------|-----------|------|-------|----|----|-------|-------|
| 1/8       | 1/8 BSP   | FFF-02G   | FFM-02G   | 34   | 36    | 18 | 18 | 24    | 11.6  |
| 1/4       | 1/4 BSP   | FFF-04G   | FFM-04G   | 49.2 | 58.2  | 20 | 20 | 28    | 16.1  |
| 3/8       | 3/8 BSP   | FFF-06G   | FFM-06G   | 55.8 | 68.2  | 24 | 24 | 32    | 19.7  |
| 3/8       | 1/2 BSP   | FFF-0608G | FFM-0608G | 59.8 | 72.2  | 27 | 27 | 32    | 19.7  |
| 1/2       | 1/2 BSP   | FFF-08G   | FFM-08G   | 72   | 75    | 32 | 32 | 38    | 24.5  |
| 1/2       | 3/4 BSP   | FFF-0812G | FFM-0812G | 76   | 79    | 36 | 36 | 38    | 24.5  |
| 5/8       | 3/4 BSP   | FFF-1012G | FFM-1012G | 75.5 | 80    | 36 | 36 | 42    | 27    |
| 3/4       | 3/4 BSP   | FFF-12G   | FFM-12G   | 93.8 | 99.8  | 41 | 41 | 48    | 30    |
| 3/4       | 1" BSP    | FFF-1216G | FFM-1216G | 93.8 | 99.8  | 41 | 41 | 48    | 30    |
| 1"        | 1" BSP    | FFF-16G   | FFM-16G   | 93.8 | 99.8  | 41 | 41 | 56    | 36    |
| 1"        | 1 1/4 BSP | FFF-1620G | FFM-1620G | 90   | 115.5 | 55 | 55 | 56    | 36    |

**FF Series Couplers UNO Thread**

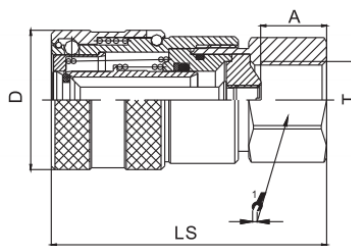
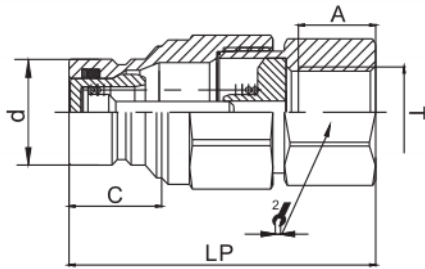

**Features:**

- ◆ Push to connect
- ◆ Pull collar back to disconnect
- ◆ Flat Valves
- ◆ Seals NBR
- ◆ Material steel
- ◆ Conforms to ISO 16208 stand-

**Common Interchange:**

- ◆ Parker FEM
- ◆ Faster FFH
- ◆ Stucchi FIRG
- ◆ Holmbury HQ
- ◆ DNP PLT4
- ◆ Aeroquip FF/FD89

| Size            | 1/8  | 1/4  | 3/8  | 1/2  | 5/8  | 3/4  | 1"   |
|-----------------|------|------|------|------|------|------|------|
| <b>MWP PSI</b>  | 6000 | 6000 | 5000 | 5000 | 5000 | 5000 | 5000 |
| <b>Flow LPM</b> | 12   | 25   | 50   | 110  | 125  | 160  | 230  |

| Body Size | Thread     | Female    | Male      | LP   | LS   | S1 | S2 | Dia D | Dia d |
|-----------|------------|-----------|-----------|------|------|----|----|-------|-------|
| 1/4       | 9/16 UNO   | FFF-0409U | FFM-0409U | 49.2 | 58.2 | 20 | 20 | 28    | 16.1  |
| 3/8       | 9/16 UNO   | FFF-0609U | FFM-0609U | 55.8 | 68.2 | 24 | 24 | 32    | 19.7  |
| 3/8       | 3/4 UNO    | FFF-0612U | FFM-0612U | 55.8 | 55.8 | 24 | 24 | 32    | 19.7  |
| 1/2       | 3/4 UNO    | FFF-0812U | FFM-0812U | 72   | 75   | 32 | 32 | 38    | 24.5  |
| 1/2       | 7/8 UNO    | FFF-0814U | FFM-0814U | 76   | 79   | 36 | 36 | 38    | 24.5  |
| 1/2       | 1 1/16 UNO | FFF-0817U | FFM-0817U | 76   | 79   | 36 | 36 | 38    | 24.5  |
| 5/8       | 1 1/16 UNO | FFF-1017U | FFM-1017U | 76   | 80   | 36 | 36 | 42    | 27    |
| 3/4       | 1 1/16 UNO | FFF-1217U | FFM-1217U | 93.8 | 99.8 | 41 | 41 | 48    | 30    |